

Vendor Table Placement

FAMIS 2011 – Turnbull Conference Center – FSU Tallahassee

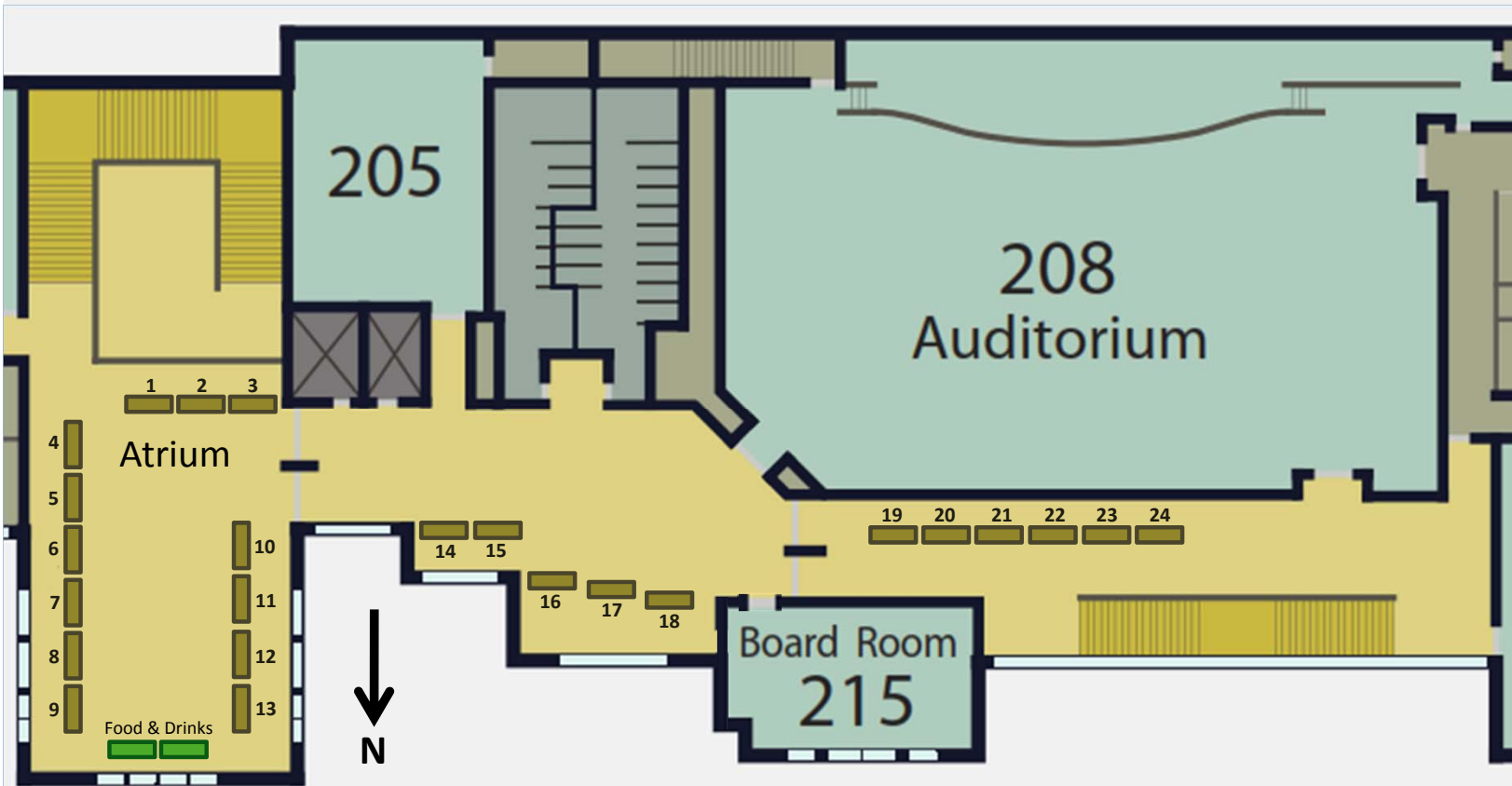

- 1 – Camcor, Inc.
- 2 – Skyward
- 3 – Verizon Wireless
- 4 – Follett Software
- 5 – Certica Solutions
- 6 – Advanced Processing & Imaging
- 7 – infosnap
- 8 – Infinite Campus
- 9 – Stoneware
- 10 – Aerohive Networks
- 11 – School Messenger
- 12 – Sungard K-12 Education
- 13 – Performance Matters
- 14 – CIPAFilter
- 15 – CPSI, Ltd.
- 16 – Internet Content Management
- 17 – Insight
- 18 – Focus School Software
- 19 – IBM
- 20 – KeepnTrack
- 21 – ShoreTel Inc.
- 22 – SHI International
- 23 – Classroom Technology Solutions
- 24 – Kaspersky Labs

All vendor tables measure 24" x 72".

Tables 1 - 13 in atrium are 3½' from wall.

Tables 11 - 15 in hallway are 3½' or more from wall.

Tables 16 - 24 in hallway are 1½' from wall.

-  Occupied Table
-  Vacant Table
-  Food & Drinks Table